

# Excel Encasa Din Rail SCA Module 4 Fibre Loaded with 4 x SCA Simplex Shuttered Adaptors

Item Code: 207-402



✕ Integrated fibre management

✕ Hinged doors

✕ DIN rail release latch

✕ Shuttered adaptors

## Product Overview

The Excel Encasa DIN rail mount box has been designed for industrial and FTTH application. The outlet is fixed direct to the DIN rail and offers a compact solution that can be installed in confined spaces requiring connectivity and comes preloaded with 4x SC/APC adaptor.

## Product Specifications

Feature	Values
Surface mounted	yes
Type of connector	SC/APC simplex
With couplers	yes
Suitable for number of couplers	4
Suitable for type of fibre	Single mode
Width	18 mm
Height	85 mm
Depth	61 mm

# Excel Encasa Din Rail SCA Module 4 Fibre Loaded with 4 x SCA Simplex Shuttered Adaptors

Item Code: 207-402



## Additional specifications

Features	Values
Material	ABS plastic
Colour	White
Operating temperature	-20 to +85 °C
UL-94-V-0	Yes

## Product drawings

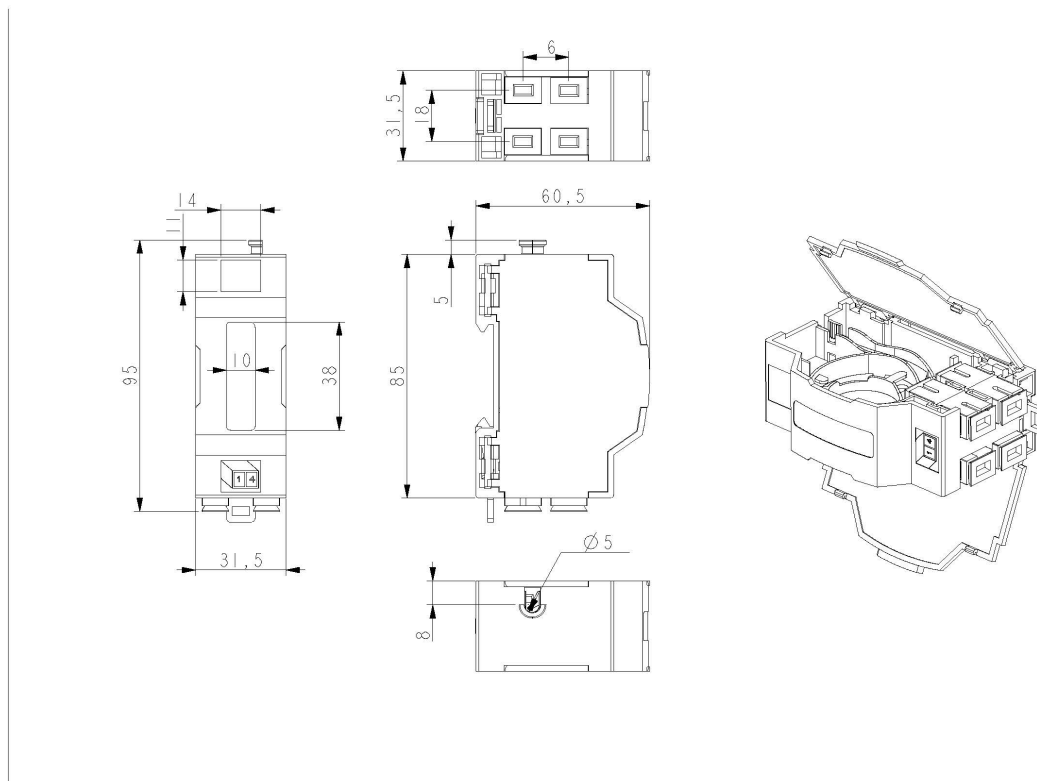

## Standards

Applicable standard	Detail
IEC 61754-1:2013	Fibre optic interconnecting devices and passive components - Fibre optic connector interfaces - Part 1: General and guidance
ISO/IEC 11801-1:2017	Information technology - Generic cabling for customer premises: Part 1 General Requirements

# Excel Encasa Din Rail SCA Module 4 Fibre Loaded with 4 x SCA Simplex Shuttered Adaptors

Item Code: 207-402



EN 50173-1:2018

Information technology. Generic cabling systems - General requirements

UL-94-V-0

Burning stops within 10 seconds after two applications of ten seconds each of a flame to a test bar. NO flaming drips are allowed.

RoHS

Compliant to the Restriction of Hazardous Substances

WFD

Compliant to Waste Framework Directive

SCIP

Compliant - Does Not Contain Substances of Concern in Products

## Part Number Table

Part Number	Description
207-402	Excel Encasa Din Rail SCA Module 4 Fibre Loaded with 4 x SCA Simplex Shuttered Adaptors

Excel is a world class premium performing end to end infrastructure solution designed, Manufactured, supported and delivered without compromise.

Contact us at [sales@excel-networking.com](mailto:sales@excel-networking.com)



E&OE. Excel is a registered trade name of Mayflex Holdings Ltd.